



**MARKWARD
GROUP**

GROUND LEASE

**8+ LEVEL ACRES
COMMERCIAL**



**7661-7671 Beth Bath Pike
Bath, PA 18014**

Features

- 8+ acres of level land
- Available immediately
- Delivery negotiable

Location

- Northampton County
- East Allen Township
- 6 miles from Lehigh Valley International Airport
- 3 miles north of Route 22 on Route 512

Zoning

- Commercial

Lease Rate

- Call for details

CONTACT

Chip Miers
Managing Director
cmiers@markwardgroup.com
610.360.8505

Ann Kline
VP / Associate Broker
akline@markwardgroup.com
610.295.6602

Del Markward, SIOR
President / Founder
dmarkward@markwardgroup.com



MARKWARD GROUP

5925 Tilghman Street, Suite 1400 | Allentown, PA 18104 | 610.295.6600

Location

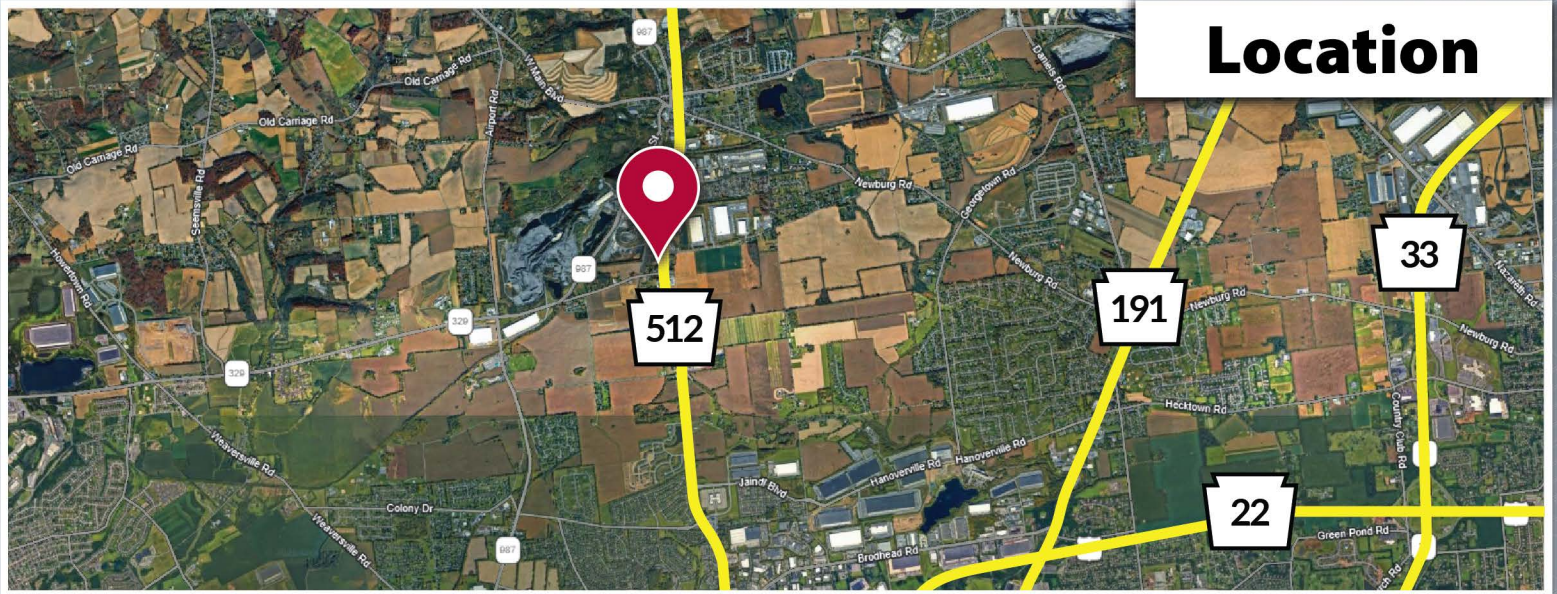

National Flood Hazard Layer FIRMeTte



75°24'3" W 40°42'51" N



Legend

SEE FIS REPORT FOR DETAILED LEGEND AND INDEX MAP FOR FIRM PANEL LAYOUT

- SPECIAL FLOOD HAZARD AREAS**
- Without Base Flood Elevation (BFE) Zone A, V, AP3
 - With BFE or Depth Zone AE, AD, AH, VE, AR
 - Regulatory Floodway
- OTHER AREAS OF FLOOD HAZARD**
- 0.2% Annual Chance Flood Hazard, Areas of 1% annual chance flood with average depth less than one foot or with drainage areas of less than one square mile Zone X
 - Future Conditions 1% Annual Chance Flood Hazard Zone X
 - Area with Reduced Flood Risk due to Levees. See Notes, Zone X
 - Area with Flood Risk due to Levees Zone D
- OTHER AREAS**
- NO SCREEN Area of Minimal Flood Hazard Zone X
 - Effective LOMRs
 - Area of Undetermined Flood Hazard Zone D
- GENERAL STRUCTURES**
- Channel, Culvert, or Storm Sewer
 - Levee, Dike, or Floodwall
- CROSS SECTIONS WITH 1% ANNUAL CHANCE WATER SURFACE ELEVATION**
- Coastal Transect
 - Base Flood Elevation Line (BFE)
 - Limit of Study
 - Jurisdiction Boundary
 - Coastal Transect Baseline
 - Profile Baseline
 - Hydrographic Feature
- OTHER FEATURES**
- Digital Data Available
 - No Digital Data Available
 - Unmapped
- MAP PANELS**
- The pin displayed on the map is an approximate point selected by the user and does not represent an authoritative property location.

This map complies with FEMA's standards for the use of digital flood maps if it is not void as described below. The basemap shown complies with FEMA's basemap accuracy standards.

The flood hazard information is derived directly from the authoritative NFHL web services provided by FEMA. This map was exported on 12/4/2023 at 1:31 PM and does not reflect changes or amendments subsequent to this date and time. The NFHL and effective information may change or become superseded by new data over time.

This map image is void if the one or more of the following map elements do not appear: basemap imagery, flood zone labels, legend, scale bar, map creation date, community identifiers, FIRM panel number, and FIRM effective date. Map images for unmapped and unmodernized areas cannot be used for regulatory purposes.

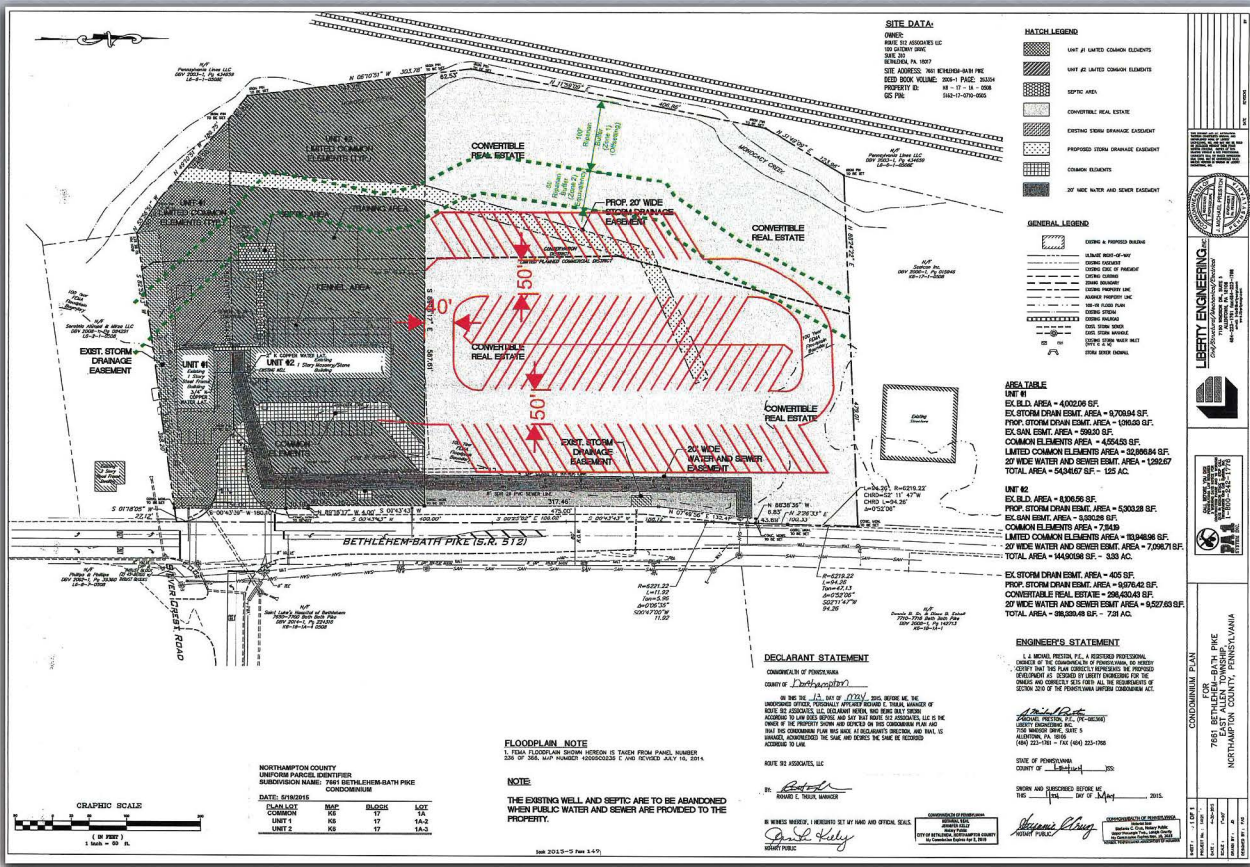

The foregoing information was furnished to us by sources which we deem to be reliable, but no warranty or representation is made as to the accuracy thereof. Subject to correction of errors, omissions, change of price, prior sale, or withdrawal from market without notice.

